

### AKIRA-PROMAX R11 INLINE AND CYLINDER LIQUID & GAS DUAL APPLICATION REGULATOR.

R11 Series stainless steel pressure regulator is Single-stage diaphragm, vacuum structure Stainless diaphragm output. It has piston pressure reducing structure, constant outlet pressure, mainly used for high input pressure, suitable for purified gas, standard gas, corrosive gas etc.



#### DESIGN FEATURES

- Single-stage reduce structure
- Use hard-seal between body and Diaphragm
- Body Thread: 1/4" NPT (F) (1/2" Adapter OPT)
- Easy to sweep inside body
- Filter mesh inside
- Panel mountable or wall mounted

#### TYPICAL APPLICATIONS

- Laboratory
- Gas Chromatograph
- Gas Laser
- Gas bus
- Oil and chemical industry
- Tested instrumentation

#### SPECIFICATION:

- Max inlet pressure : 5400psig (372 Bar)
- Outlet pressure : 0~25, 0~50, 0~100, 0~250, 0~500 psig
- Proof pressure: 1.5 times of maximum rated pressure
- Working Temp: -40°C~+74°C
- Leakage rate:  $2 \times 10^{-8}$  atm cc/sec He
- Cv : 0.08

#### MATERIAL: Weight: 0.9kg

- Body: 316L, Brass
- Roof: 316L, Brass
- Diaphragm: 316L
- Filter mesh: 316L (10μ m)
- Valve seat: PCTFE, PTFE, Vespel
- Spring loaded: 316L
- Valve disc regulation pole: 316L
- Ready for Oxygen services

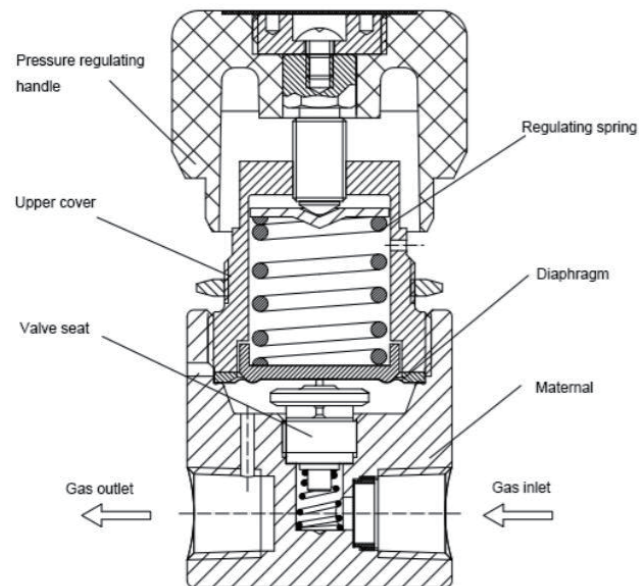

### FLOW DATA

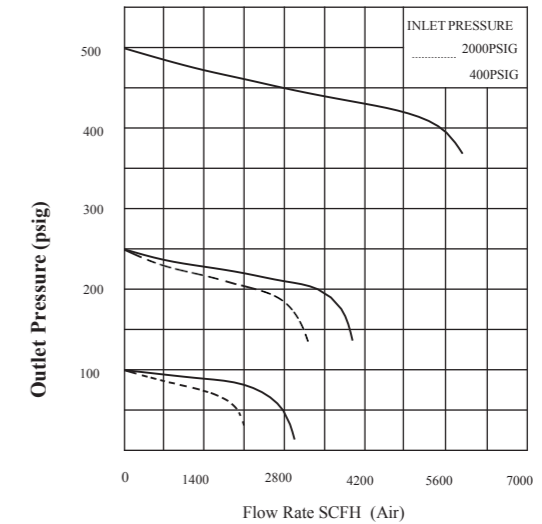
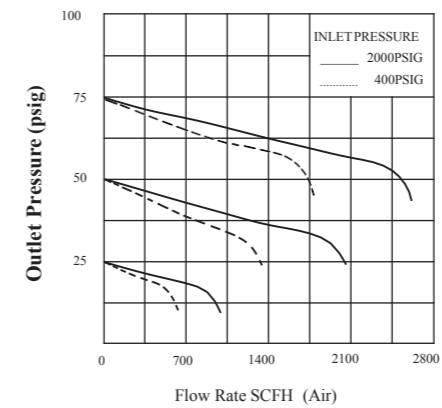

### DIMENSIONS:

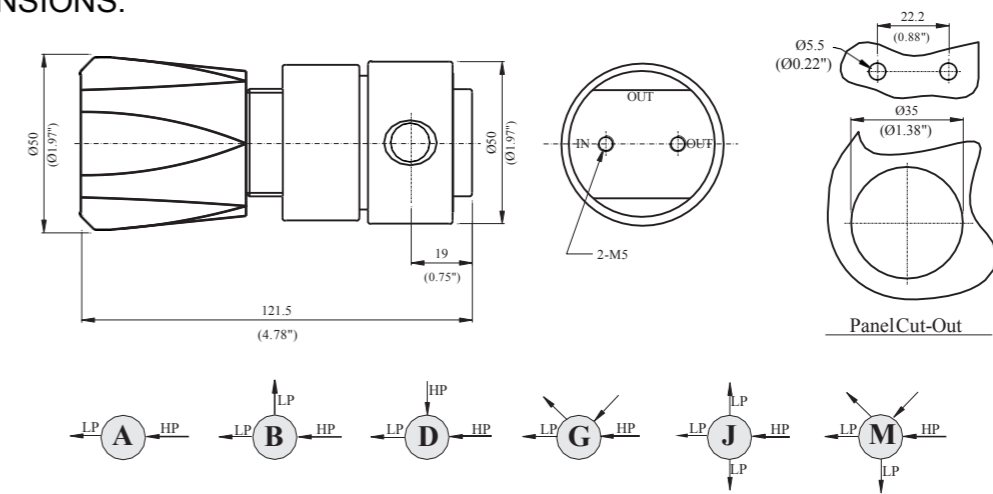

### ORDERING INFORMATION

R11 Item	L Body Materia	B Body Hole	D Inlet pressure	F Outlet pressure	G Pressure gauge	00 Inlet size	00 Outlet size	P mark
R11	L: 316 B: Brass	A B D G J M	D: 3000 psi E: 2200 psi F: 500 psi	F: 0-500 psi G: 0-250 psi I: 0-100 psi K: 0-50 psi L: 0-25 psi	G: MPa gauge P: Psig/bar gauge W: No gauge	00: 1/4" NPT (F) 01: 1/4" NPT (M) 23: CGA330 24: CGA350 27: CGA580 28: CGA660 30: CGA590 52: G5/8"-RH(F) 63: W21.8-14H(F) 64: W21.8-14LH(F)	00: 1/4" NPT(F) 01: 1/4" NPT(M) 10: 1/8" OD 11: 1/4" OD 12: 3/8" OD 15: 6mm OD 16: 8mm OD	P: Panel mounting R: With relief valve N: Needle valve D: Diaphragm valve